



# Ordering Information

## FEP Introcan® Safety™ IV Catheter

| Material | Size | Catheter Length | Straight or Wing | Reorder Number* |
|----------|------|-----------------|------------------|-----------------|
| FEP      | 24G  | ¾ inch          | S                | 4252500         |
| FEP      | 24G  | ¾ inch          | W                | 4254503         |
| FEP      | 22G  | 1 inch          | S                | 4252519         |
| FEP      | 22G  | 1 inch          | W                | 4254511         |
| FEP      | 20G  | 1 inch          | S                | 4252543         |
| FEP      | 20G  | 1 inch          | W                | 4254546         |
| FEP      | 20G  | 1¼ inch         | S                | 4252535         |
| FEP      | 20G  | 1¼ inch         | W                | 4254538         |
| FEP      | 20G  | 1¾ inch         | S                | 4252527         |
| FEP      | 18G  | 1¼ inch         | W                | 4254562         |
| FEP      | 18G  | 1¼ inch         | S                | 4252560         |
| FEP      | 18G  | 1¾ inch         | S                | 4252551         |
| FEP      | 16G  | 1¼ inch         | S                | 4252586         |
| FEP      | 16G  | 2 inches        | S                | 4252578         |
| FEP      | 14G  | 1¼ inch         | S                | 4251890         |
| FEP      | 14G  | 2 inches        | S                | 4252594         |

## Polyurethane Introcan® Safety™ IV Catheter

| Material | Size | Catheter Length | Straight or Wing | Reorder Number* |
|----------|------|-----------------|------------------|-----------------|
| PUR      | 24G  | ¾ inch          | S                | 4251601         |
| PUR      | 24G  | ¾ inch          | W                | 4253523         |
| PUR      | 22G  | 1 inch          | S                | 4251628         |
| PUR      | 22G  | 1 inch          | W                | 4253540         |
| PUR      | 20G  | 1 inch          | S                | 4251652         |
| PUR      | 20G  | 1 inch          | W                | 4253574         |
| PUR      | 20G  | 1¼ inch         | S                | 4251644         |
| PUR      | 20G  | 1¼ inch         | W                | 4253566         |
| PUR      | 18G  | 1¼ inch         | S                | 4251687         |
| PUR      | 18G  | 1¼ inch         | W                | 4253604         |
| PUR      | 18G  | 1¾ inch         | S                | 4251679         |
| PUR      | 16G  | 1¼ inch         | S                | 4251709         |
| PUR      | 16G  | 2 inches        | S                | 4251695         |

\* Shipping case contains 200 catheters (4 boxes of 50)

For more product information, contact your local B. Braun representative, or call 1-800-BBRAUN2 (227-2862).

Rx only

Introcan® Safety and Working Together for Excellence in Safety are trademarks of B. Braun Medical Inc., and Introcan, SAFSITE and ULTRASITE are registered trademarks of B. Braun Medical Inc. © Copyright B. Braun Medical Inc. 2002

VAD11 rev. 04/02



B. Braun Medical Inc.  
824 Twelfth Avenue  
Bethlehem, PA 18018  
www.bbraunusa.com



## IV Catheters

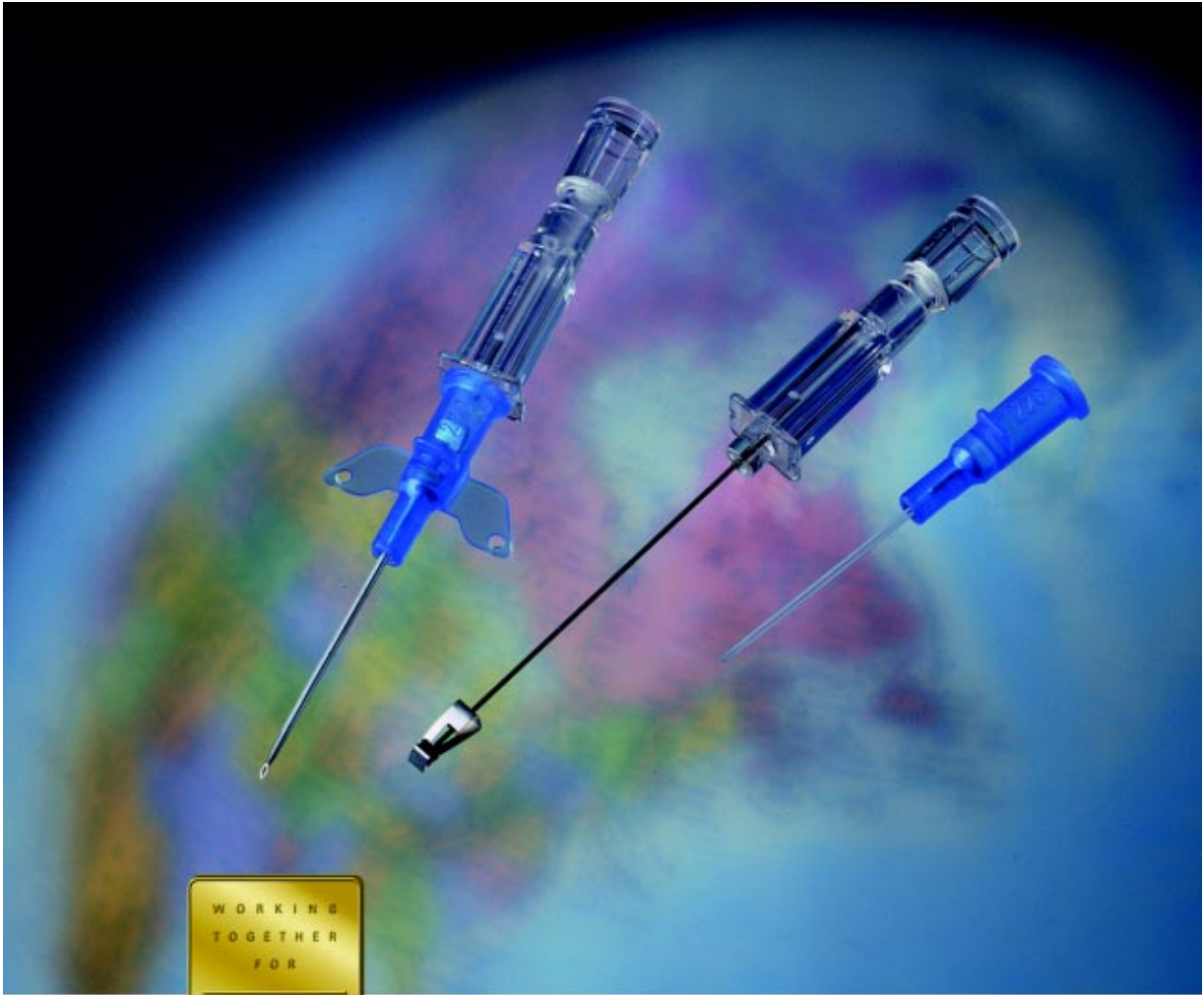

Passive design minimizes needlestick injuries without requiring user activation



# Introcan® Safety™ IV Catheter

B. Braun Medical Inc. is a global leader in Intravenous Therapy-related products and services. Our mission is to provide the medical community with world-class devices and solutions, affording the best total value in improving the safety and clinical effectiveness for patients and healthcare workers throughout the continuum of care. One of our main areas of expertise is Vascular Access, where B. Braun has designed, manufactured, and distributed over 1 billion IV catheters worldwide. As a pioneer in safety product innovation, B. Braun produced the world's first passive needlefree IV system, SAFSITE®, followed by the first positive pressure capless valve, ULTRASITE®, and was also the first US manufacturer to offer non-PVC/DEHP-free IV bags. Working together with clinical experts, B. Braun continues this proud tradition of excellence in safety with the passive Introcan® Safety™ IV Catheter. The Introcan® Safety™ Catheter portfolio is a major component of B. Braun's safety initiative: People, Products, Programs — Working Together for Excellence in Safety™.



## Passive Safety IV Catheter

- Ergonomically designed to minimize accidental needlestick injuries, without requiring user activation
- Requires minimal in-servicing and a short learning curve
- Eliminates risk of inadvertent activation
- Compliance virtually assured since safety mechanism cannot be bypassed



## Convenient Syringe Attachment

- Unique design allows pre-attachment of a syringe to the IV catheter
- Preattachment of a syringe does not compromise the safety feature
- All syringes with Luer connections are compatible with the Introcan® Safety™ IV catheter, facilitating aspiration and injection during insertion
- B. Braun latex-free syringes are available in a variety of sizes



## Unique Hub Design

- Push-off plate on the hub ensures smooth insertion, allowing a single-handed technique
- Needle bevel orientation indicated on Push-off plate
- Transparent, ISO Standard color coded hubs are clearly embossed with catheter size
- Locking bevel indicator eliminates catheter rotation prior to insertion

## Additional Features

- Sharp needle bevel and rounded catheter tip for smooth venipunctures
- Clear, radiopaque striped material for easier catheter visualization
- Available in both FEP and polyurethane
- Available with and without wings
- Latex-free; DEHP/PVC free



**B | BRAUN**

## In-Servicing Made Simple



The Introcan® Safety™ IV Catheter features a safety clip, a passive engineering control pre-assembled inside the catheter hub.



The safety clip is automatically engaged when the needle bevel exits the catheter hub.



The safety clip's patented design permanently attaches to the needle bevel to minimize inadvertent needlestick injuries.

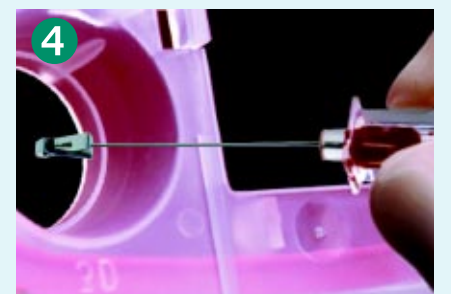

Always follow CDC Guidelines and/or your facility's protocol and dispose of sharps immediately into a sharps container.



Complimentary in-servicing materials include practice suggestions poster, in-service video, and IV access practice device.